

INSTINCT® | PRO



Tulla Floor Standing Bath Shower Mixer Installation Instructions

www.instinctproducts.co.uk

About Installation

Care must be taken during installation to prevent damage to the product or injury to the installer.

Installation must be carried out by a qualified and competent person, and in accordance with the instructions supplied with the product.

All installations must comply with Local and National regulations.

Please ensure that you have read and understood all sections of this guide BEFORE installation.

Water Regulations

Although this product has been designed for use in all types of systems, the water supply to your taps must be connected in accordance with the water regulations, and good plumbing practice.

We recommend that hot and cold water supplies to the tap are at equal pressure, in order to give consistent flow. If this is not possible, non-return valves must be fitted to both supplies in accordance with current Water Regulations. These recommendations apply to both mains and tank fed systems.

Flushing

The water regulations requires fittings to be flushed before first use. We recommend that supplies are thoroughly flushed to remove debris BEFORE making any pipe connection to the tap. Failure to do so could result in damage to the product or unsatisfactory performance.

Water Pressure

Models are advertised as suitable for either Low, Medium or High pressure.

Low pressure models suitable for 0.1 bar+

Medium pressure models suitable for 0.5 bar+

High pressure models are suitable for 1bar+

At high pressure, excessive flow may be reduced by fitting Flow Restrictors. Fitting a Stop Valve or Service Valve in the pipework will allow your tap to be conveniently isolated for maintenance.

Note: Models are supplied with either aerator, flow straightener or open spout for controlled flow.

Some open spout models are supplied with flow restrictors for fitment on hose inlet to restrict flow at higher pressures (1bar+ recommended) for pleasant stream.

Flow restrictors or alternative outlets can be purchased separately if required.

Prior to Installation

1. Check that the supplied product is correct and complete and has no surface damage
2. Ensure that all existing pipe work has been flushed and that the pipe work is prepared for the installation of your new tap
3. Isolate the water supply by closing the stop cock or isolating valves

Important – Care & Maintenance

1. Chrome surface should only be cleaned using a soft non abrasive cloth and clean water. Mild detergent can be used to clean
2. Never use household cleaners which contain bleach or abrasive cleaners

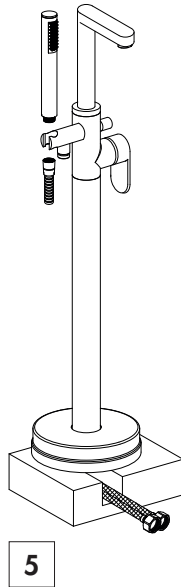
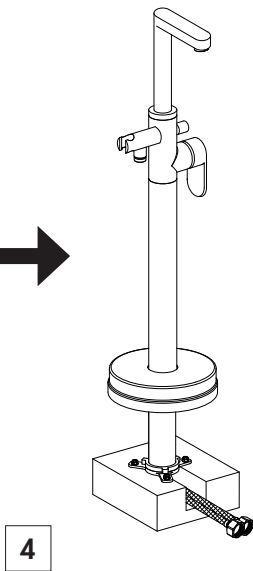
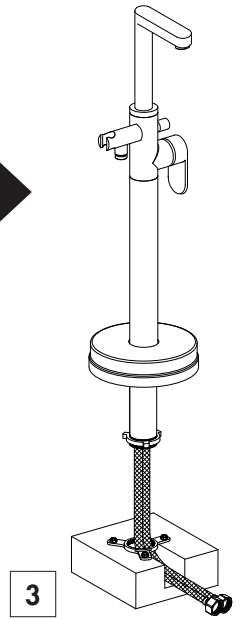
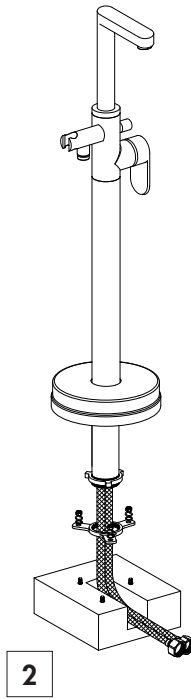
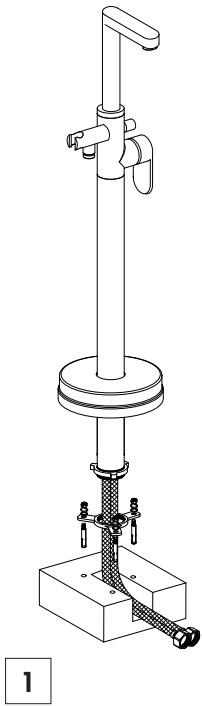

INSTINCT® | PRO

Product Support

T: 02891 828000 (Technical Support)

E: support@aquallabrassware.com

www.instinctproducts.co.uk