

Thirn Thermostatic Wall Mounted Bath Shower Mixer INSTTHN-WB



Specification

| | |
|------------------------|--------------------------------|
| Finish | Chrome |
| Dimensions | 105(h) x 274(w) x 228(d) mm |
| Weight | 1.67kg |
| Body | Brass |
| Spout Material | Brass |
| Fittings | Brass legs, metal nuts, washer |
| Connection | 3/4" BSP Threaded tail |
| Cartridge Size | #25 Cartridge |
| Flow Restrictor | No |
| Max Static Pressure | 5.0 Bar |
| Min Operating Pressure | 1.0 Bar |
| Max Operating Pressure | 5.0 Bar |
| Max Water Temperature | 60°C |

Flow Rates

| Pressure | 0.2 | 0.5 | 1 | 3 |
|--------------|-----|-----|----|------|
| Flow Aerator | 3.8 | 7.9 | 12 | 21.5 |

All Pressures in Bar. All flow in L/Min. Dimensions supplied are nominal and subject to tolerance. Inclusion or restrictors (sold separately unless stated) will affect flow rate result. Performance details are based on trials under test conditions and for guidance only. The Company reserves the right to change product specification without prior notice.

Spares

Diverter Cartridge SPO6-THN-WB

Thermostatic Cartridge SP12-THN-WB

The Company is not responsible for the installation of the spares supplied, which must always be fitted by a competent person. Parts supplied are in many cases identical to the original component whilst others are offered as a suitable alternative. All spares listed are suitable for direct replacement unless stated. The Company reserves the right to change product specification without prior notice.

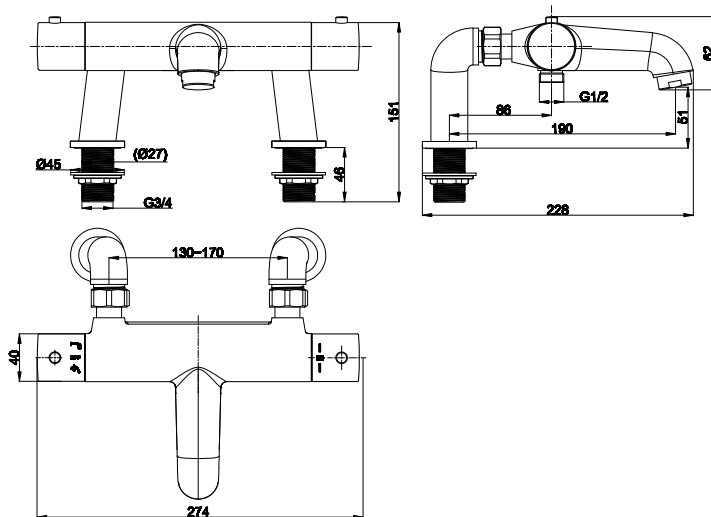

Key Features + Benefits

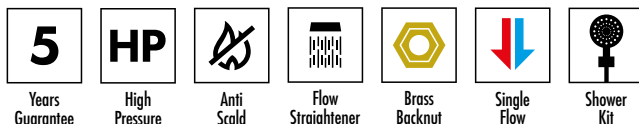

Certifications + Approvals

Aqualla Brassware

Unit 3 & 4 16 Crawfordsburn Road Newtownards County Down BT23 4EA. Technical Support – Tel: +44 (0) 28 9182 8000 Email: support@aquallabrassware.com

All information on the data sheet is correct at the time of publication. All measurements are approximate and subject to standard tolerances.