

Loch Quick Release, Wrap-Over, Soft Close, Slim Seat + Cover INSLO004SLIM

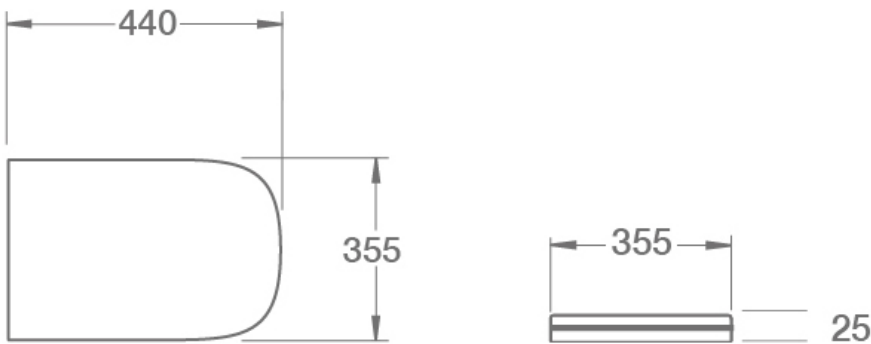

Specification

Finish	Oak
Dimensions	25(h) x 355(w) x 440(d) mm
Weight	2.65kg
Seat Hinge Material	Metal / Plastic
Antibacterial Protection	Yes
Seat Type	Slim Wrap Over
UV Protection	Yes
Max Load Test	150kg
Seat Material	Duraplus



Key Features + Benefits

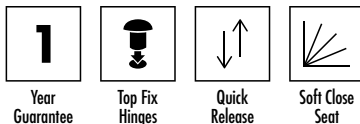

Certifications + Approvals

Imex Ceramics

15 Millbrook Industrial Estate, Sybron Way, Crowborough TN6 3DU. Technical Support – Tel: 01530 835598 Email: sales@imexceramic.co.uk

All information on the data sheet is correct at the time of publication. All measurements are approximate and subject to standard tolerances.