

Technical Data Sheet | Modular Furniture

www.instinctproducts.co.uk

los J-Pull 500mm Floor Standing Two Door Basin Unit INST04126, INST04127, INST04128



Specification

Finish	Gloss White (INST04126) Gloss Light Grey (INST04127) Gloss Anthracite (INST04128)
Dimensions	860(h) x 505(w) x 385(d) mm
Weight	20.5kg
Carcass Thickness	16mm
Carcass Material	MDF
Carcass Finish	Painted and Melamine Faced
Internal Cabinet Colour	As exterior
Plumbing Void	55mm
Cabinet Fixing Type	-
Door / Drawer Finish	Painted
Door / Frontal Material	MDF
Number of Doors	Two
Number of Drawers	None
Number of Internal Shelves	One (Fixed)
Door Handing	-
Hinge / Runner Type	Soft Close
Handle / Knob	None
Handle Centres	-
Pre-Drilled / Marked for handles	-

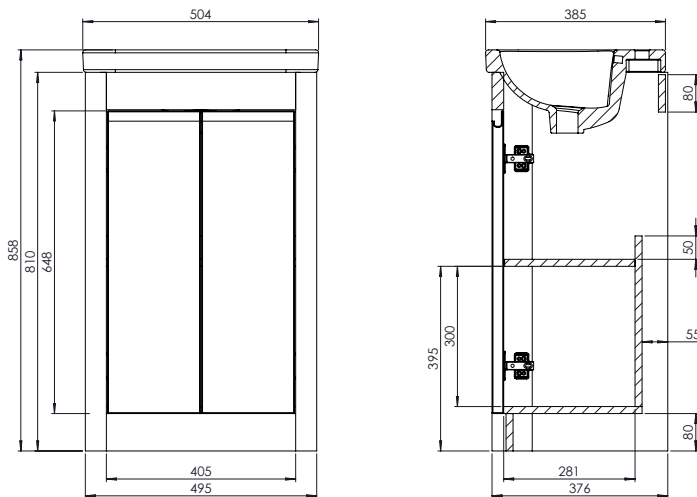

FAQs

Please see next page

Key Features + Benefits



5
Years
Guarantee



Soft Close
Doors



One Internal
Shelf



Plumbing
Void



One Taphole
Basin

Certifications + Approvals

Roper Rhodes

Brassmill Lane Trading Estate, Bath, BA1 3JF. Technical Support – Tel: 01225 303 900 Email: sales@roperrhodes.co.uk

All information on the data sheet is correct at the time of publication. All measurements are approximate and subject to standard tolerances.

los J-Pull 500mm Floor Standing Two Door Basin Unit INST04126, INST04127, INST04128

FAQs

Q – How big is the plumbing void?

A – 55mm.

Q – Are the hinges soft close?

A – Yes, the hinges are soft close.

Q – How deep is the unit with door open?

A – Approx. depth with 90° opening is 576mm.

Q – Can the doors be adjusted?

A – The door can be adjusted as detailed in the supplied instructions.

Q – Is the door universal?

A – No, there is a left hand and a right hand door, available as spares.

Q – How thick is the door fascia?

A – The door is 25mm thick.

Q – Is the shelf removable?

A – No, the shelf cannot be removed.

Q – What is the shelf capacity?

A – Shelf max depth: 281mm.

Q – How many shelves are there?

A – There is one shelf and a base within the unit.

Q – Is the shelf adjustable?

A – No, the shelf is fixed in position.

Q – What is the interior finish of the unit?

A – The unit interior is the same finish as the exterior.

Q – What basins are compatible with this unit?

A – The los 500mm Ceramic Basin (INST041072)