

Instinct Eco-Mag

Installation & Servicing Instructions

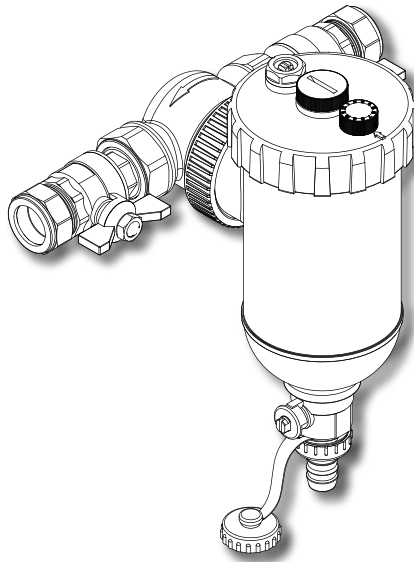

In this procedure document we have endeavoured to make the information as accurate as possible.

We cannot accept any responsibility should it be found that in any respect the information is inaccurate or incomplete or becomes so as a result of further developments or otherwise.

Intatec Ltd

Airfield Industrial Estate
Hixon
Staffordshire
ST18 0PF

Tel: **01889 272 180**

Fax: **01889 272 181**

email: **sales@intatec.co.uk**

web: **www.intatec.co.uk**

INSTALLATION

The Eco-Mag Pro triple action filter is suitable for any central heating installation and can be fitted in any orientation on the central heating circuit.

For best performance enhancement and filter protection however, we recommend that the Eco-Mag is installed on the return leg of the circuit, between the last radiator and the boiler to gain the maximum advantage.

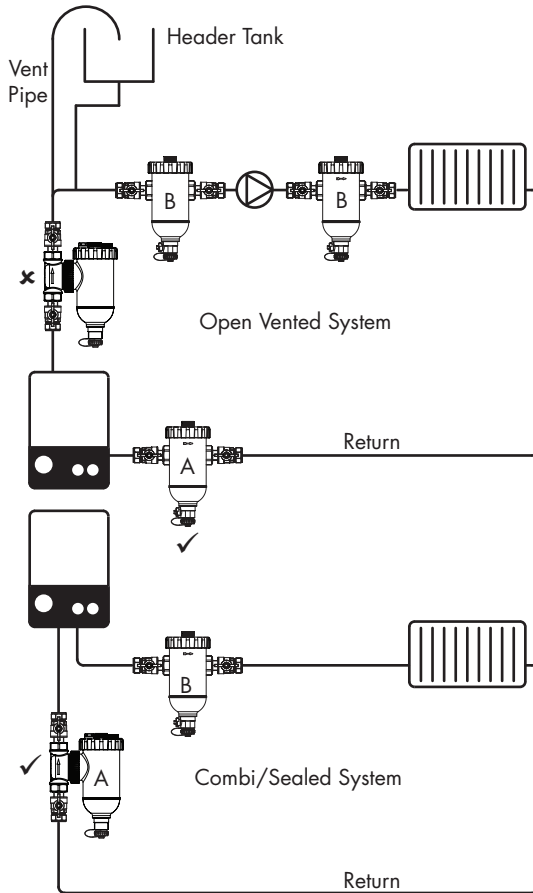

In both diagrams, position A is best practice whilst B is suitable

COMPONENTS

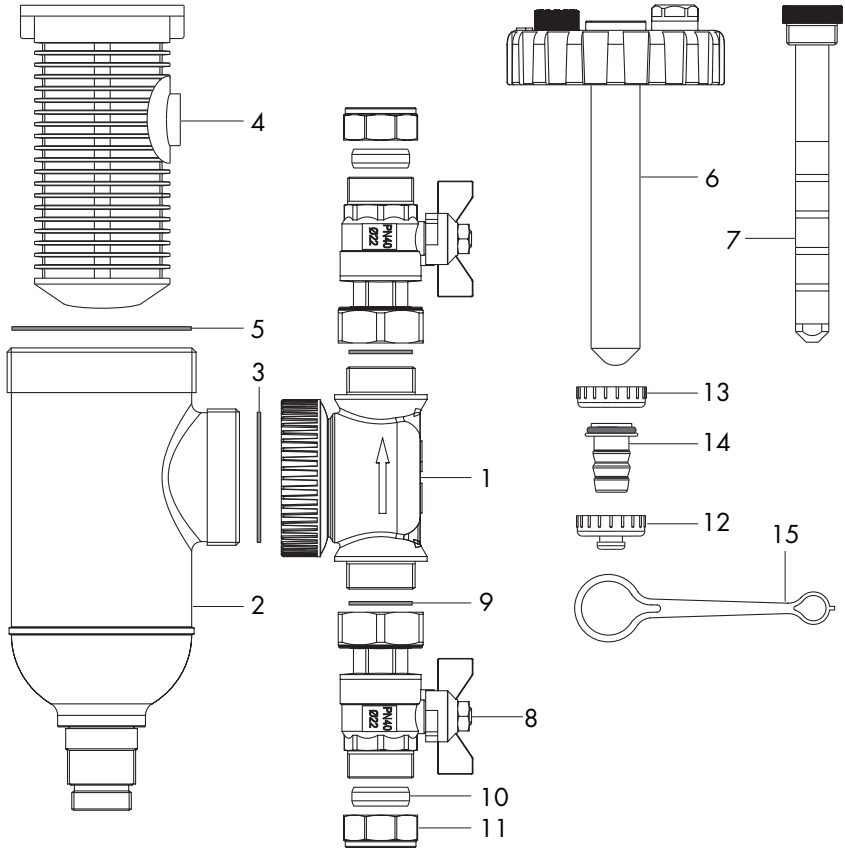

Item	Qty	Component	Item	Qty	Component
1	1	Connection block	8	2	Ball valve
2	1	Chamber	9	2	Ball valve seal
3	1	Body seal	10	2	Olive
4	1	Non ferrous filter	11	2	Compression nut
5	1	Cap seal	12	1	Drain valve blank
6	1	Screw cap including air vent and date wheel	13	1	Hose union nut
7	1	Removeable magnet	14	1	Hose union tail
			15	1	Retaining strap

INSTALLATION

Ensure that the system is suitably drained down and all system pressure has been released.

On open vented systems, make sure that the feed and expansion tank is either isolated or “tied up”.

When siting the Instinct Eco-Mag, great care should be taken on installation so the removeable magnet and screw cap can be easily removed and sufficient space should be left to allow air bleeding and dosing.

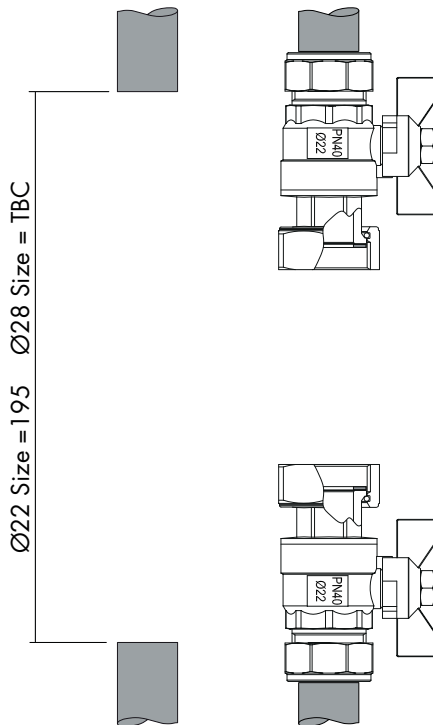

Having removed the prescribed section of pipework, make sure that the open ends of both pieces are free of debris and ready to receive the nut and olive. Fit both isolation valves but do not tighten fully.

Slip the brass connection block between the isolation valves, taking particular care to ensure that the directional arrow on the connection block is pointing in the direction of the flow of water. Failure to do so will result in reduced flow and inhibited filter performance

INSTALLATION

Hand tighten the isolation valves to the connection block making sure that the rubber washers provided have been situated between the two. When you are happy that the connection block and isolating valves are facing an appropriate direction for the installation, fully tighten all four nuts.

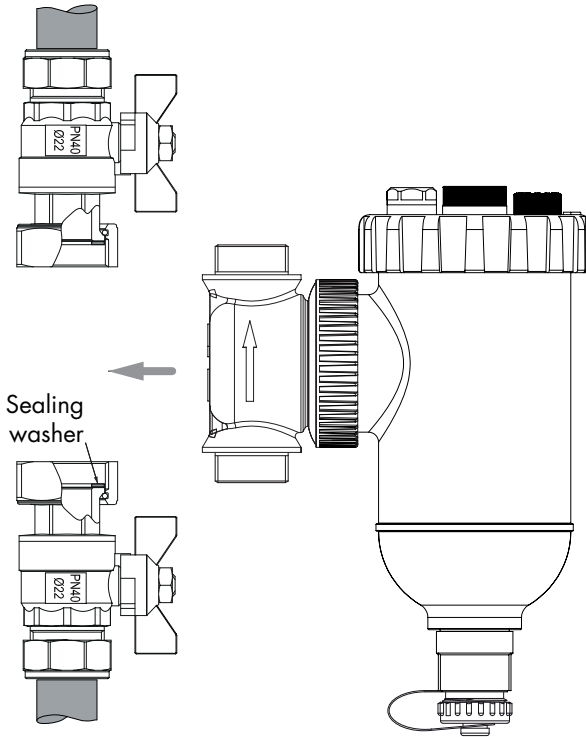

Present the filter to the brass connection block making sure that the drain valve is at the bottom and the screw cap is at the top.

Gently push the filter into the connection block, ensuring that all the sealing 'O' rings are present, and when you are satisfied with the position of the filter, hand tighten. If further tightening is required, gentle pressure can be applied with a suitably sized set of pump pliers.

WARNING - EXCESSIVE TIGHTENING OF THE CONNECTION BLOCK/FILTER UNION MAY IRREPARABLY DAMAGE THE FILTER.

COMMISSIONING

The commissioning procedure should be carried out as follows;

- 1 Open the lower isolation valve to the **Eco-Mag** – leave the upper most isolation valve closed. The air bleed should be closed initially during commissioning.
- 2 Making sure that all open ends of the system are closed, begin to refill the system.
- 3 Bleed radiators as required.
- 4 Return to the **Eco-Mag** filter and open the air bleed until water flows from it. 5
Open the top isolation valve and allow the remaining system volume to fill.
- 6 Open the air bleed again to ensure all air has been removed from the filter.
- 7 When the filter has been fully commissioned adjust the date wheel on the screw cap of the filter to reflect the month in which the installation took place. This can then act as a service schedule guideline for both the installer and end user.

N.B. – Air may continue to be present in system pipework for a small period as the central heating is run after installation of the **Eco-Mag**. We recommend that you check the air bleed again to ensure that all air has been purged from the system.

CLEANING AND SERVICING

Prior to cleaning the **Eco-Mag**, ensure that the working environment is safe.

We recommend that you turn the boiler off before commencing any maintenance works.

Firstly, turn the isolation valves to the closed position; then, open the air bleed to relieve any system pressure.

Unscrew the magnet from its threaded connection in the top of the screw cap and pull it free, leaving the screw cap attached to the filter body. This will demagnetise the contents of the filter and any magnetic debris should fall to the bottom of the filter body.

Making sure that the surrounding area is covered and a suitable container is on hand to receive the filter discharge, open the drain valve at the bottom of the filter. Once the flow of water has stopped, the filter is empty.

Completely remove the screw cap from the filter body and then rinse any remaining magnetite from the screw cap and magnet shroud. At this time, the non ferrous filter can also be removed from the filter body and rinsed with clean water.

CLEANING AND SERVICING

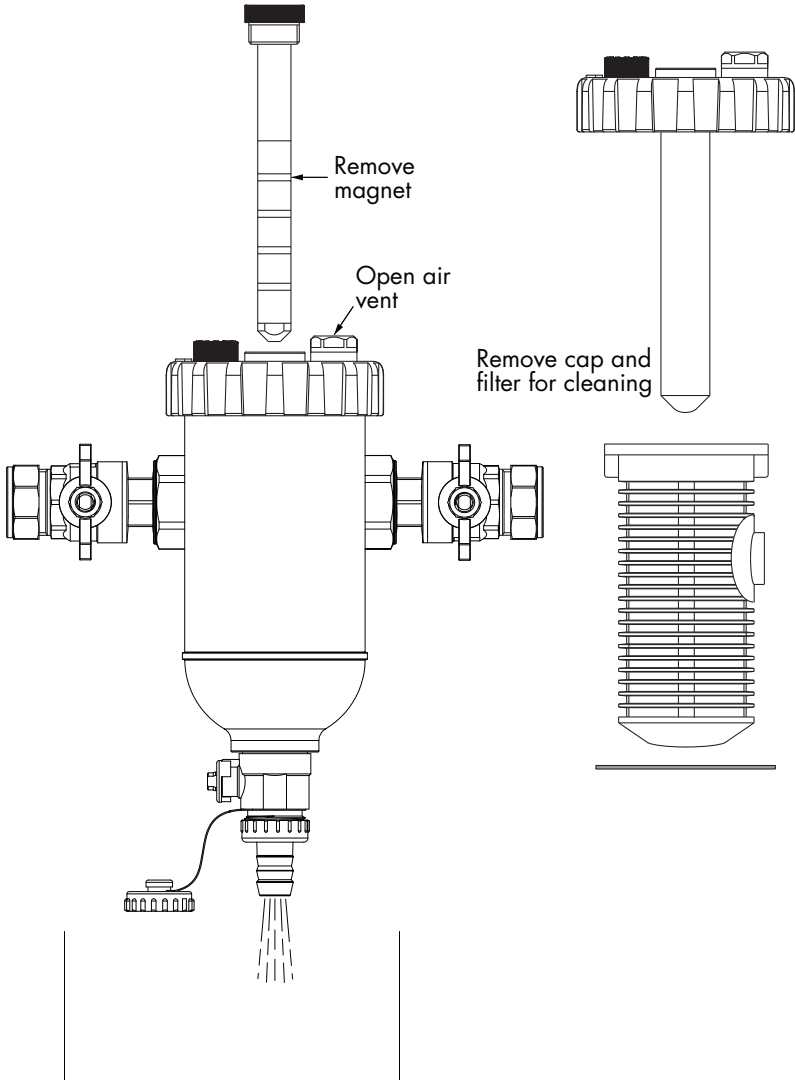

ADDING WATER TREATMENT

Before any chemical dosing is attempted, first ensure that the central heating system is suitably isolated, (i.e. water is isolated at the point it feeds the system, float valves are either isolated or "tied up"), and that system pressure has been relieved.

To dose from the **Eco-Mag**, turn the top isolation valve into the off position but leave the lower valve open.

Drain an appropriate volume of water from the system at its lowest point to allow for the dosing volume.

The **Eco-Mag** has a large 500ml dosing capacity, which, in most cases, should prove sufficient. Open the drain valve and drain the remaining system contents from the filter body.

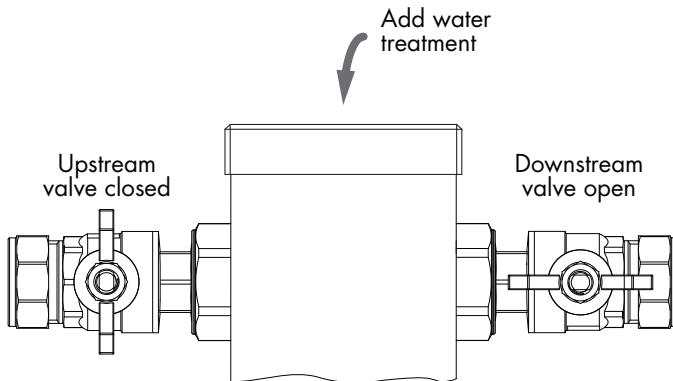

When the filter is clear of debris and water, remove the screw cap from the top of the filter body and dose according to system requirement. Re-commission the system as per the previous instructions in the COMMISSIONING section.

NOTES

NOTES

NOTES

NOTES

Please Leave this Manual for the User

To activate your product warranty please visit
www.intatec.co.uk
and click on Product Registration



Intatec Ltd

Airfield Industrial Estate
Hixon
Staffordshire
ST18 0PF

Tel: **01889 272 180**

Fax: **01889 272 181**

email: **sales@intatec.co.uk**

web: **www.intatec.co.uk**