

Instinct 8 Three Panel Bath Screen INB9



Specification

| | |
|--------------|----------------------|
| Frame Finish | Chrome |
| Glass Finish | Clear |
| Cover Finish | Chrome |
| Fixings | Concealed |
| Seals | Yes |
| Dimensions | 1500(h) x 1400(w) mm |
| Adjustment | 1380-1400mm |
| Weight | 46kg |

Features

| | |
|-----------------|--------------------|
| Safety Standard | BS EN 14428 |
| Components | See following page |

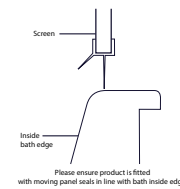
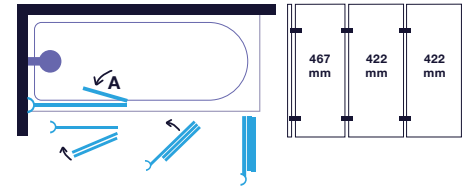

Door Swing: 180°

A: Radius of Screen Swing = 500mm

☉ Recommended shower head position

Key Features + Benefits

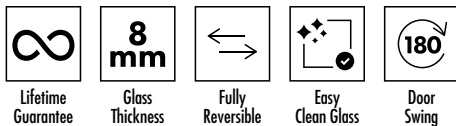

Certifications + Accreditations



Merlyn Showering

Merlyn House, Unit 8, Purcellsinch Industrial Estate, Dublin Road, Kilkenny R95 HP71 Ireland. Tel: Freephone 0808 1011 429 Email: spec@merlyn.ie

All information on the data sheet is correct at the time of publication. All measurements are approximate and subject to standard tolerances.

Instinct 8 Three Panel Bath Screen INB9

Components

| No. | Description | Qty | Part No. | No. | Description | Qty | Part No. |
|-----|--------------------------------|-----|----------|-----|-----------------------|-----|----------|
| 1 | Cover cap for wall profile L/R | 2 | M7017 | 10 | Luna rail end cap L/R | 2 | M7010UR |
| 2 | Wall profile | 1 | M7013 | 11 | Luna rail | 1 | M7014 |
| 3 | Cover strip | 1 | M7004 | 12 | Bottom seal | 2 | M7016 |
| 4 | Moving panel | 1 | A | 13 | Moving panel | 1 | B |
| 5 | Screw ST4x12 | 3 | A2401201 | 14 | Hinge(in side) | 2 | M7006 |
| 6 | Wall plug | 4 | B08070 | 15 | Vertical magnet seal | 2 | M7008 |
| 7 | Flat head screw ST4x30 | 4 | 2YS51 | 16 | Cover cap for hinge | 16 | M7012 |
| 8 | Plastic part for cover strip | 3 | M7009 | 17 | Hinge(out side) | 2 | M7018 |
| 9 | Bottom seal | 1 | M7015 | 18 | Moving panel | 1 | C |

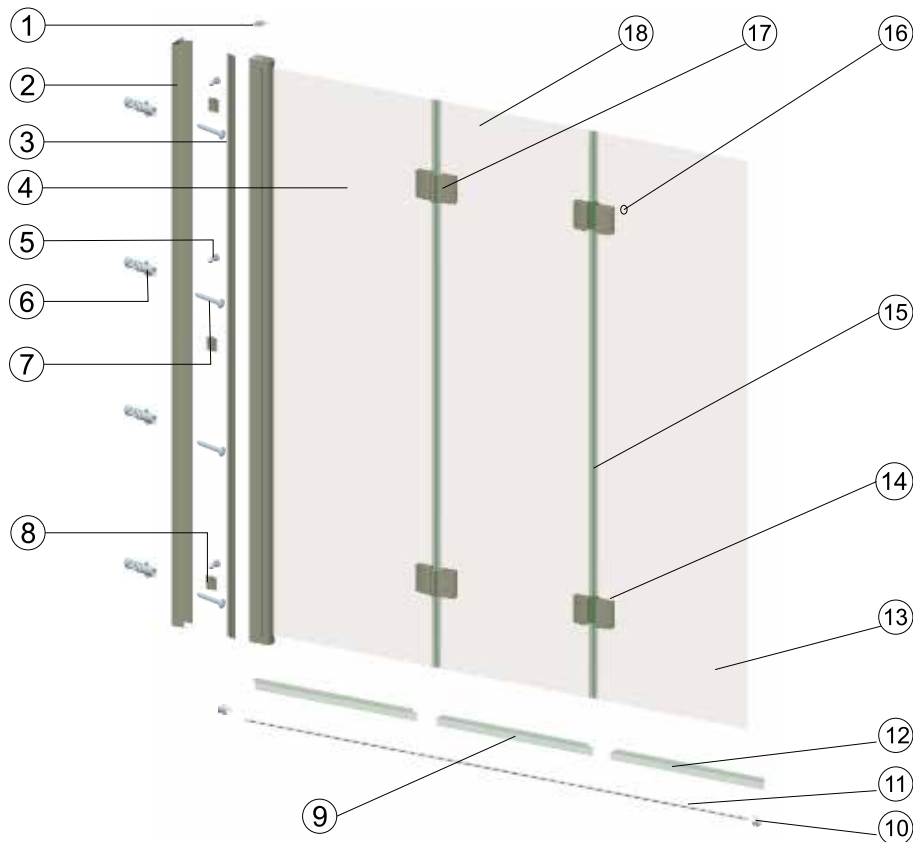

Merlyn Showering

Merlyn House, Unit 8, Purcellsinch Industrial Estate, Dublin Road, Kilkenny R95 HP71 Ireland. Tel: Freephone 0808 1011 429 Email: spec@merlyn.ie

All information on the data sheet is correct at the time of publication. All measurements are approximate and subject to standard tolerances.