

Icaria 400mm Ceramic One Taphole Basin INST041500



Specification

Finish	White
Dimensions	151(h) x 397(w) x 212(d) mm
Weight	9kg
Basin Material	Ceramic
Overflow	Yes
Chainstay Hole	No
Reversible	Yes
Taphole Positioning	Side
Tap	Not included
Waste	Not included

FAQs

Please see next page

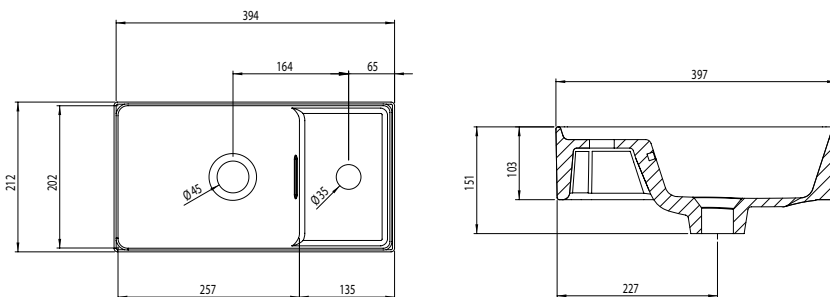

Key Features + Benefits



5
Years
Guarantee



One Taphole
Basin

Certifications + Approvals

Roper Rhodes

Brassmill Lane Trading Estate, Bath, BA1 3JF. Technical Support – Tel: 01225 303 900 Email: sales@roperrhodes.co.uk

All information on the data sheet is correct at the time of publication. All measurements are approximate and subject to standard tolerances.

Icaria 400mm Ceramic One Taphole Basin INST041500

FAQs

Q – What is the maximum water depth of the basin?

A – 55mm up to the overflow.

Q – What is the width of the Tapledge?

A – The Tapledge is 135mm wide.

Q – What is the distance from the Taphole centre to Basin Waste?

A – 164mm

Q – Does the basin have an overflow?

A – Yes, integrated.

Q – Is the basin glazed on all sides?

A – Yes, so the basin can be handed left or right.