

Close Coupled Sensor Flush Kit (ø38mm Cistern Hole) INST02041



Specification

Finish	Chrome
Flush Button Dimensions	ø38(w) mm
Kit Weight	0.51kg
Flush (Single / Dual)	Dual

Features

Compatibility	To upgrade to the contactless flush kit, the following cisterns are compatible – Espada, Keros, Kinsley and Lissett
Controls	Infrared
Fixings Included	Yes
Installation	The flush kit is compatible with most paddle operated flush valves for retrofit applications. If retrofitting to cisterns with cable operated or screw in buttons, replace flush valve with the Paddle Operated Close Coupled Dual Flush Valve (INST02043) which has a 2" base

FAQs

Please see next page



Flush kit

ø38mm flush button

Key Features + Benefits

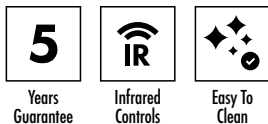

5
Years
Guarantee

IR
Infrared
Controls

Easy To
Clean

Certifications + Approvals

Roper Rhodes

Brassmill Lane Trading Estate, Bath, BA1 3JF. Technical Support – Tel: 01225 303 900 Email: sales@roperrhodes.co.uk

All information on the data sheet is correct at the time of publication. All measurements are approximate and subject to standard tolerances.

Close Coupled Sensor Flush Kit (ø38mm Cistern Hole) INST02041

FAQs

Q – Which WCs is this compatible with?

A – This is compatible with any paddle operated flush valve with a cistern lid hole from 38mm to 46mm
It is compatible with the following Instinct ranges – Espada, Keros, Kinsley and Lissett cisterns

Q – How do I activate the reduced/full flush?

A – The reduced flush is activated by waving your hand over the sensor. The full flush is activated by holding your hand over the sensor for 1 second.

Q – How much room is required around the sensor?

A – You should leave around 30cm of clear room above the sensor to prevent it from being triggered when not required.

Q – How can use this product if I don't have a paddle operated flush valve?

A – A paddle operated flush valve can be retro-fitted and can purchased using the code INST02043.

Q – What type of batteries does this product take?

A – 4 x AA with an expected battery life of 12 months.

Q – Is this product supplied with batteries?

A – No.

Q – Can the toilet be flushed when the batteries run out?

A – Yes, the button still has a manual full flush option.

Q – Is there an installation video?

A – Yes, scan the QR code below.



For a quick installation guide, follow the instructional video by scanning the QR code on your smart device

Parts Guide

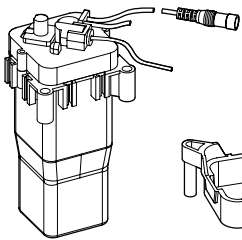

1x Control Box

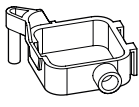

1x Battery Box Cradle



1x Battery Box

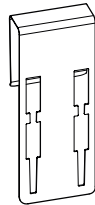

1x Stainless Steel Hanger

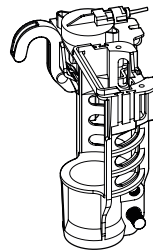

1x Clamp and Pneumatic Hook



1x Clamp Collar

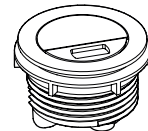

1x Button with Securing Nut

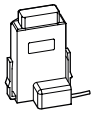

1x IR Sensor