

Concealed Shower Kit Accessories Installation & Aftercare Instructions

Suitable for the installation of:

Two Function Concealed Shower Systems

Introduction

Thank you for choosing this R2 product. This guide covers the installation of shower accessories sold with R2 shower systems. Please retain this installation guide for future reference.

Installation - Wall Elbow

Square Wall Elbow Installation:

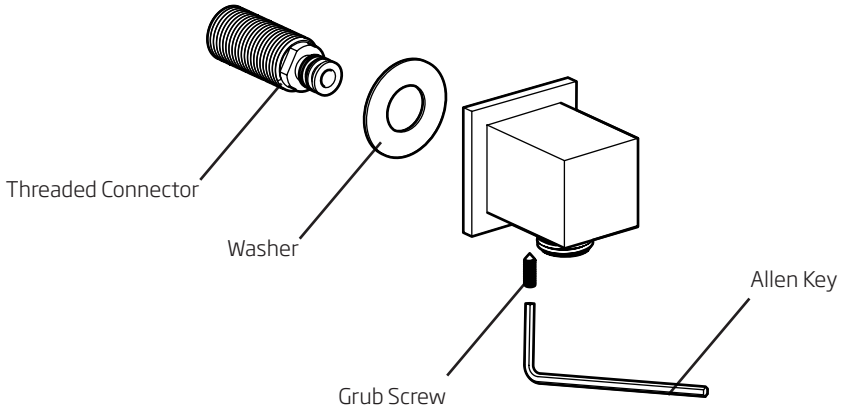

Round Wall Elbow Installation:

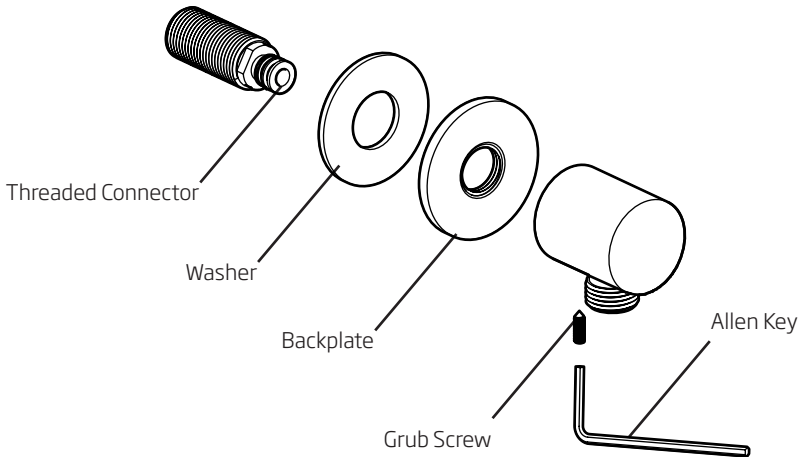

1. Remove the shower elbow from the threaded connector by loosening the grub screw.
2. Using an appropriate 1/2" BSP female threaded fitting (not supplied), secure the threaded connector to the outlet pipework. Use PTFE tape on the threaded surface to ensure a water-tight seal.

Note: The threaded connector needs to protrude 20mm from the front of the finished wall surface to allow the wall elbow to be attached securely.

3. Once the final wall surface is in place, assemble the shower elbow and cover plate to the threaded connector and secure with the grub screw.

Installation - Shower Arm

Use the following instructions for the installation of your shower arm outlet:

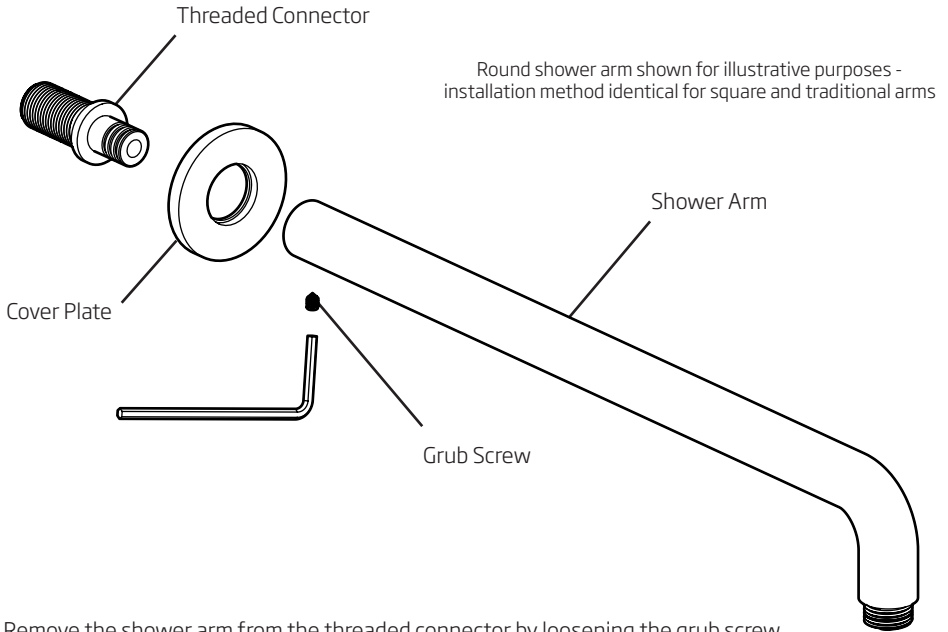

1. Remove the shower arm from the threaded connector by loosening the grub screw.
 2. Using an appropriate 1/2" BSP female threaded fitting (not supplied), secure the threaded connector to the outlet pipework. Use PTFE tape on the threaded surface to ensure a water-tight seal.
- Note:** The threaded connector needs to protrude 20mm from the front of the finished wall surface to allow the wall elbow to be attached securely. (See Below)
3. Once the final wall surface is in place, assemble the shower elbow and cover plate to the threaded connector and secure with the grub screw.

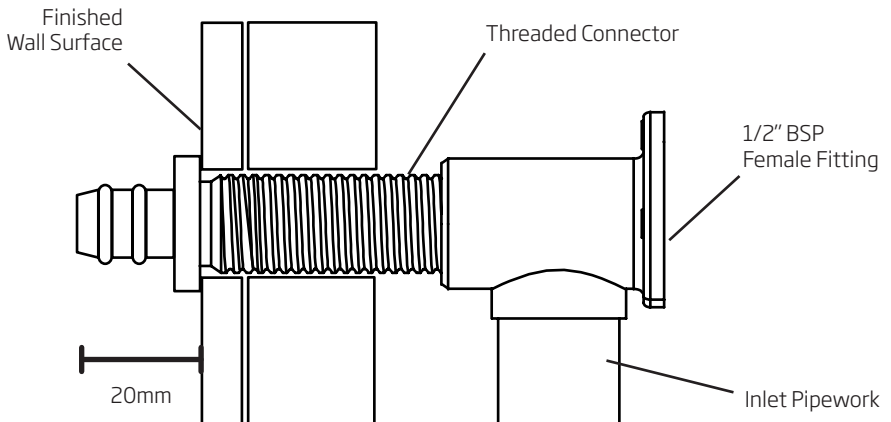

Installation - Round Riser Rail

If your shower system includes the round, quick release riser rail, please use the following instructions:

Wear suitable eye protection when drilling. Take care when using power tools near water - the use of a residual current device (RCD) is advised. Beware of hidden cables or pipes. Take care if drilling on tiled surfaces in case the drill slips. A piece of masking tape applied to the wall before marking out the fixing holes will stop the drill from wandering.

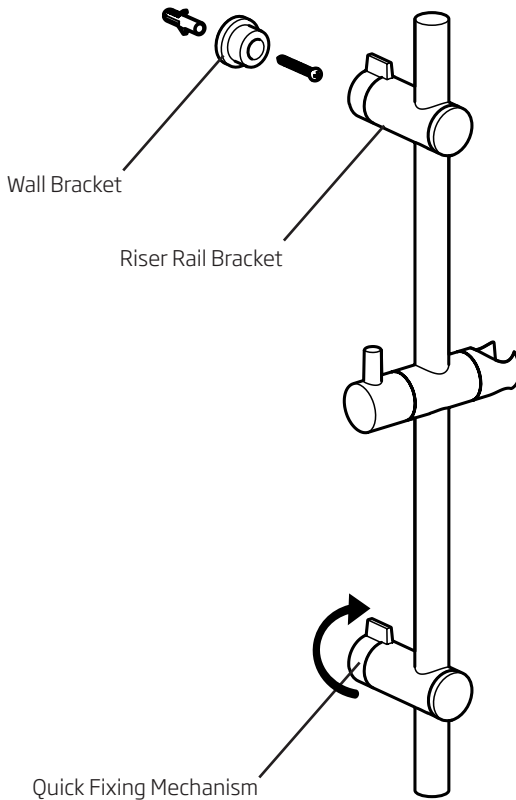

1. Measure the fixing point locations for the riser rail. On tiled surfaces it is recommended to use masking tape to mark the chosen position. This will also help prevent the drill from wandering.

Note:The two riser rail brackets are adjustable, but the maximum recommended distance of the bracket centres is 640mm.

2. Drill an appropriate sized hole for the wall plugs provided. Fix the plastic wall brackets to the wall with the fixing screws provided.

3. Secure the riser rail to the wall brackets by rotating the tab on the quick fixing mechanism

Installation - Square Riser Rail

If your shower system includes the square riser rail, please use the following instructions:

Wear suitable eye protection when drilling. Take care when using power tools near water - the use of a residual current device (RCD) is advised. Beware of hidden cables or pipes. Take care if drilling on tiled surfaces in case the drill slips. A piece of masking tape applied to the wall before marking out the fixing holes will stop the drill from wandering.

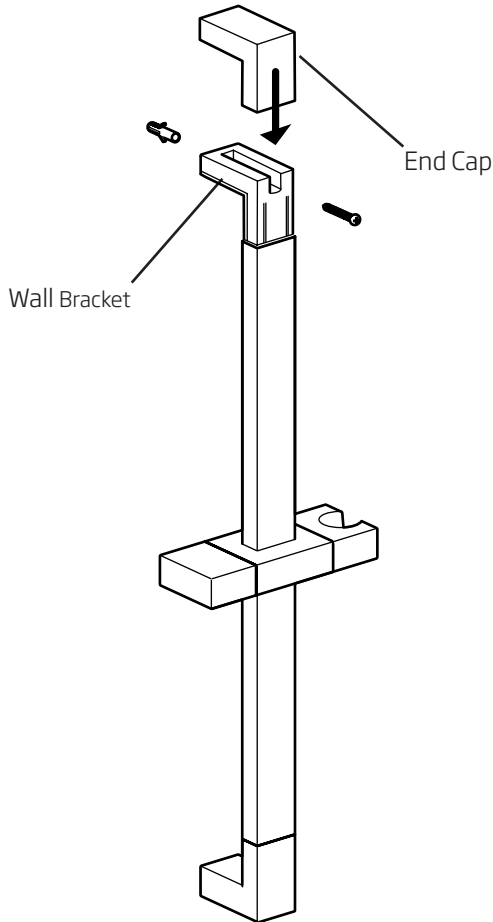

1. Remove the chrome end caps from the riser rail to allow access to the wall brackets
2. Measure the distance between the two fixing holes and use masking tape to mark the hole positions on the wall. This will also help prevent the drill from wandering.
3. Drill an appropriate sized hole for the wall plugs provided. Fix the plastic wall brackets to the wall with the fixing screws provided.
4. Cover up the fixing screws and wall brackets with the end caps.

Installation - Traditional Riser Rail

If your shower system includes a traditional riser rail, please use the following instructions:

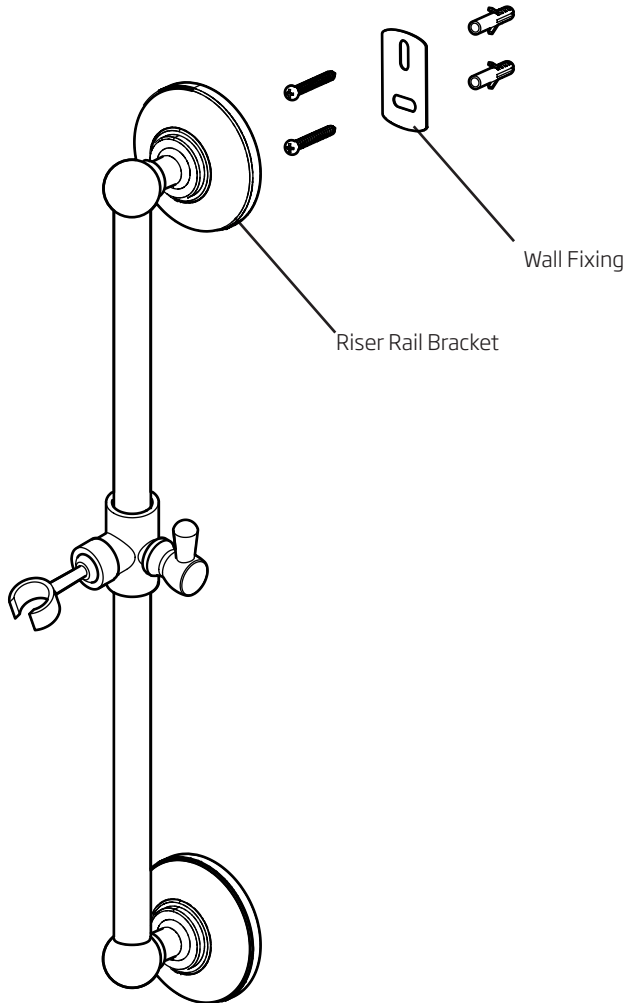

1. Remove the wall fixings from the riser rail using the grub screw on the riser rail bracket
2. Measure the distance between the two wall brackets and use masking tape to mark the hole positions on the wall. This will also help prevent the drill from wandering.
3. Drill an appropriate sized hole for the wall plugs provided. Fix the wall brackets to the wall with the fixing screws provided. There are two slotted holes to make small adjustments to the bracket position.
4. Assemble the riser rail onto the wall brackets and fix in place with the grub screws.

Customer Services, Brassmill Lane Trading Estate, Bath, BA1 3JF

Tel: 01225 303 900