

## Technical Data Sheet | Modular Furniture

www.instinctproducts.co.uk

### Andros 600mm Floor Standing Two Door Basin Unit

INST04112123, INST04112124, INST04112125, INST041123, INST04112128



#### Specification

Finish	Gloss White (INST04112123) Matt Stone Grey (INST04112124) Gloss Light Grey (INST04112125) Matt Dark Blue (INST041123) Matt Nordic Green (INST04112128)
Dimensions	870(h) x 590(w) x 439(d) mm
Weight	26kg
Carcass Thickness	16mm
Carcass Material	MDF
Carcass Finish	Painted
Internal Cabinet Colour	-
Plumbing Void	55mm
Cabinet Fixing Type	Fix to wall via back brace
Door / Drawer Finish	Painted
Door / Frontal Material	MDF
Number of Doors	Two
Number of Drawers	None
Number of Internal Shelves	One (Fixed)
Door Handing	-
Hinge / Runner Type	Soft close
Handle / Knob	Two chrome plated handles (supplied)
Handle Centres	-
Pre-Drilled / Marked for handles	Pre-fitted

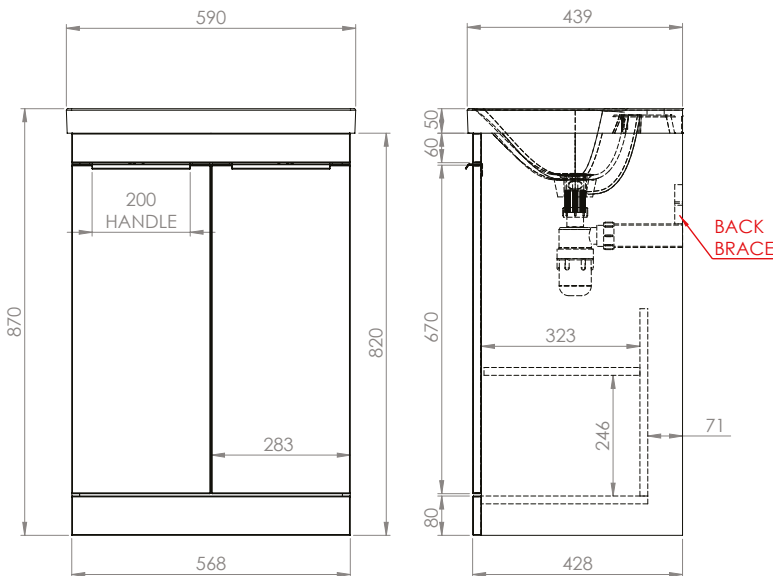

#### Key Features + Benefits

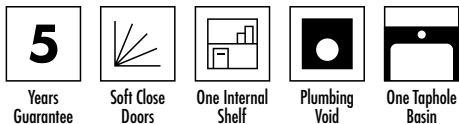

#### FAQs

Please see next page

#### Certifications + Approvals

#### Roper Rhodes

Brassmill Lane Trading Estate, Bath, BA1 3JF. Technical Support – Tel: 01225 303 900 Email: sales@roperrhodes.co.uk

All information on the data sheet is correct at the time of publication. All measurements are approximate and subject to standard tolerances.

### Andros 600mm Floor Standing Two Door Basin Unit

INST04112123, INST04112124, INST04112125, INST041123, INST04112128

#### FAQs

**Q – How big is the plumbing void at the back of the furniture?**

A – 55mm.

**Q – Are the handles fitted?**

A – Yes, handles are pre-fitted.

**Q – Are the hinges soft close?**

A – The hinges are both soft close and quick release.

**Q – Can the doors be adjusted?**

A – The doors of the unit can be adjusted as detailed in the supplied instructions.

**Q – How deep is the unit when the doors are fully open?**

A – Approx. 595mm including handle. (approx 90° opening).

**Q – Is the shelf removable?**

A – No, There is one fixed shelf.