

Technical Data Sheet | Modular Furniture

www.instinctproducts.co.uk

Andros 500mm Floor Standing Two Door Basin Unit

INST04112119, INST04112120, INST04112121, INST041122, INST04112127



Specification

Finish	Gloss White (INST04112119) Matt Stone Grey (INST04112120) Gloss Light Grey (INST04112121) Matt Dark Blue (INST041122) Matt Nordic Green (INST04112127)
Dimensions	870(h) x 490(w) x 389(d) mm
Weight	21kg
Carcass Thickness	16mm
Carcass Material	MDF
Carcass Finish	Painted
Internal Cabinet Colour	-
Plumbing Void	50mm
Cabinet Fixing Type	Fix to wall via back brace
Door / Drawer Finish	Painted
Door / Frontal Material	MDF
Number of Doors	Two
Number of Drawers	None
Number of Internal Shelves	One (Fixed)
Door Handling	-
Hinge / Runner Type	Soft close
Handle / Knob	Two chrome plated handles (supplied)
Handle Centres	-
Pre-Drilled / Marked for handles	Pre-fitted

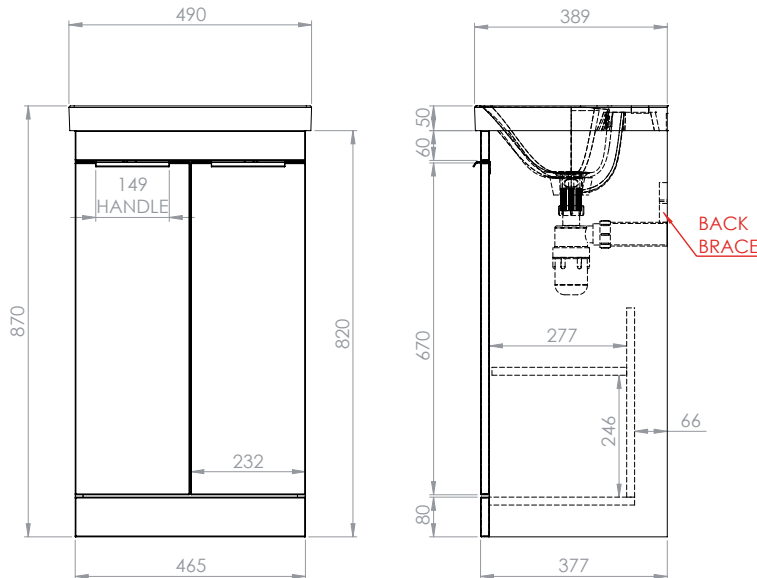

FAQs

Please see next page

Key Features + Benefits

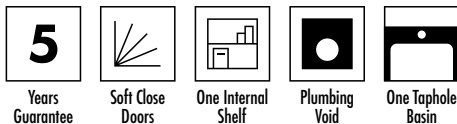

Certifications + Approvals

Roper Rhodes

Brassmill Lane Trading Estate, Bath, BA1 3JF. Technical Support – Tel: 01225 303 900 Email: sales@roperrhodes.co.uk

All information on the data sheet is correct at the time of publication. All measurements are approximate and subject to standard tolerances.

Andros 500mm Floor Standing Two Door Basin Unit

INST04112119, INST04112120, INST04112121, INST041122, INST04112127

FAQs

Q – How big is the plumbing void at the back of the furniture?

A – 50mm.

Q – Are the handles fitted?

A – Yes, handles are pre-fitted.

Q – Are the hinges soft close?

A – The hinges are both soft close and quick release.

Q – Can the doors be adjusted?

A – The doors of the unit can be adjusted as detailed in the supplied instructions.

Q – How deep is the unit when the doors are fully open?

A – Approx. 595mm including handle. (aprox 90° opening).

Q – Is the shelf removable?

A – No, There is one fixed shelf.