

800 VANITY UNIT

INSTALLATION & AFTERCARE INSTRUCTIONS

Furniture Care Instructions

As with all wooden furniture, this product should be treated with care.

We recommend...

Wipe away any water splashes or condensation after use. Excessive exposure to water will deteriorate the furniture.

All bathrooms should be well ventilated with a suitable extractor fan.

To remove dirt or fingerprints, clean with a soft damp cloth and mild soapy water. Ensure this is dried immediately.

Use a wax free polish if one must be used.

For removal of lime scale deposits use a suitable proprietary cleaner. If necessary test on an inconspicuous area first.

Please DO NOT...

Do not scrub or scour.

Do not use abrasive cleaning agents.

Before installation

For floor standing units intended to be attached to the building: **WARNING** in order to prevent overturning this product must be used with the wall attachment device provided.

It is recommended that the unit and basin are secured to a suitably reinforced wall to ensure stability. This can be done through the back rail (fixings not included).

Fitting Worktop with Underslung Basin

- Follow supplementary instructions supplied with worktop and basin for fitting basin to worktop.
- Apply a layer of silicone sealant to the worktop on all 4 sides to be fixed to the panels, back rail and front section. See Figure 2.

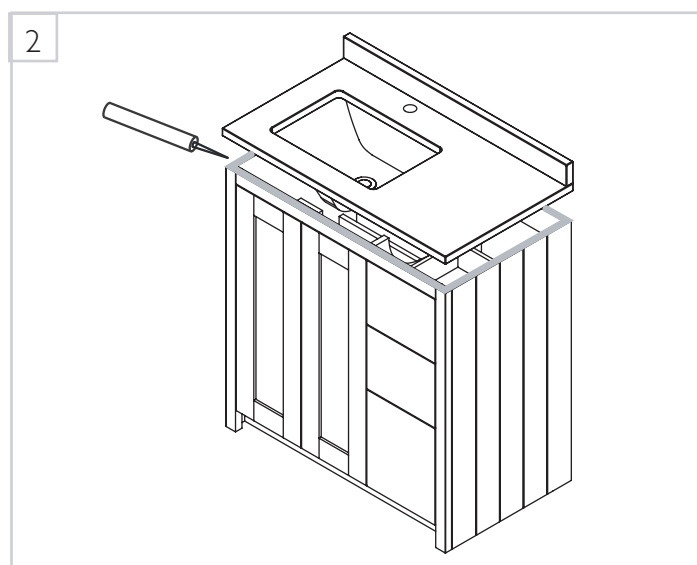
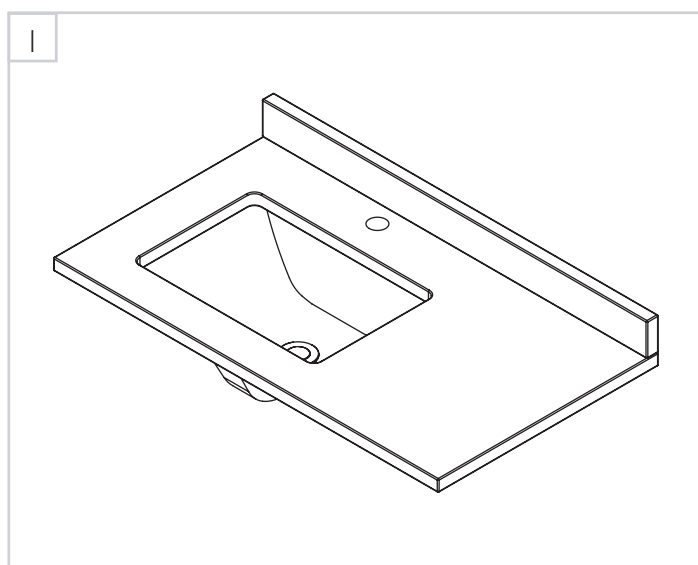

800 VANITY UNIT

INSTALLATION & AFTERCARE INSTRUCTIONS

Fixing Handles

- A pilot hole located at the back of the door can be drilled if using a single screw knob
- If you have chosen a pull handle with 2 screws then please pilot and then drill through the door with the handles in the desired location.
- Carefully drill any holes using a clamped block of wood to protect the front of door - See figure 1.
- The handles can simply be screwed into place using the screws supplied.
- If you choose third party handles please measure carefully before drilling.

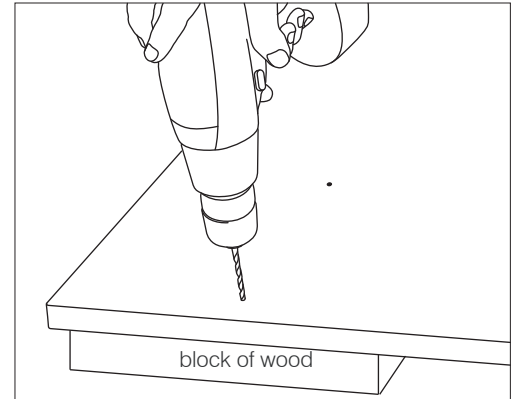

Door adjustment

The unit doors can be adjusted or removed if necessary. There are two adjustment screws on the hinges which make the adjustments shown in the image below. The quick release button on the back of the hinge can be used to remove the door completely.

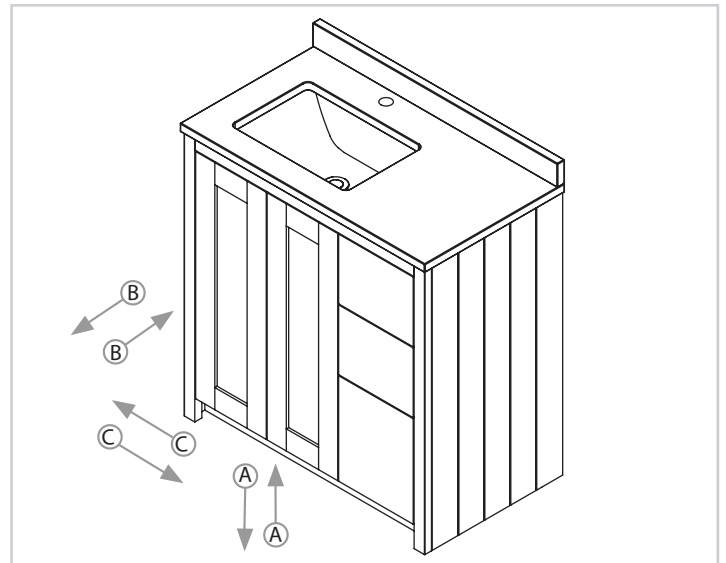
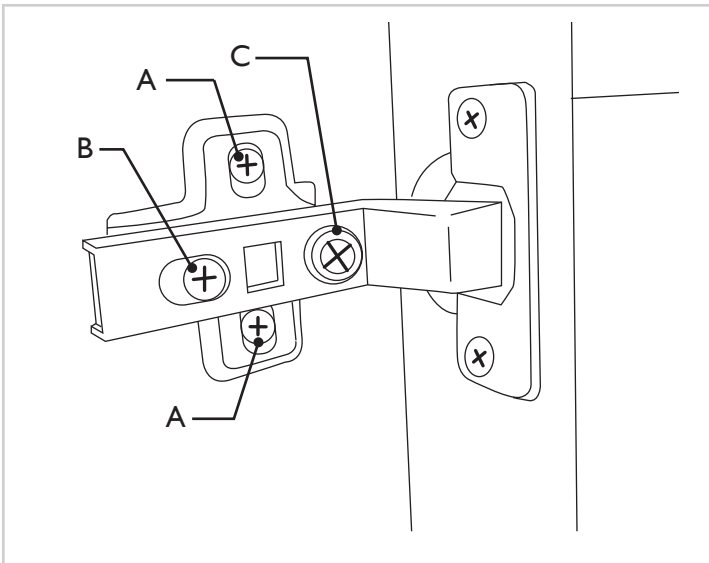

800 VANITY UNIT

INSTALLATION & AFTERCARE INSTRUCTIONS

To remove the drawer - pull drawer out and pull up vertically in one sudden and firm motion.

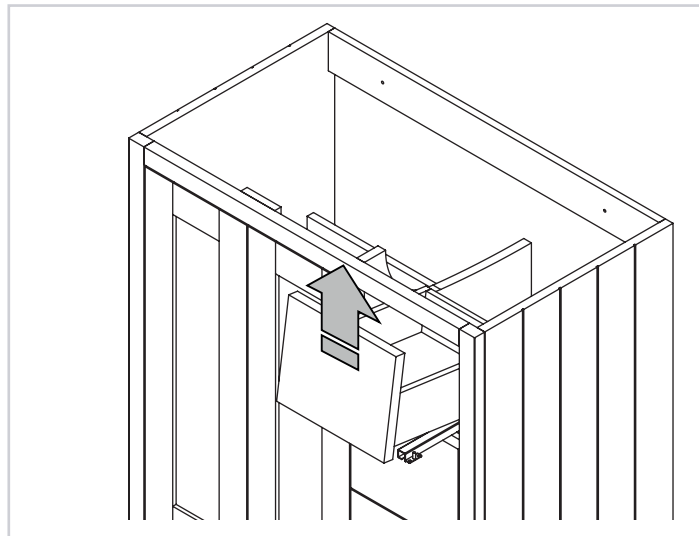

Drawer Adjustment

To adjust drawer positioning vertically the adjustment wheel on underside of drawer needs to be wound left or right depending on direction needing to adjust.

An adjustment of up to 4mm can be made.

Adjust both evenly.

